

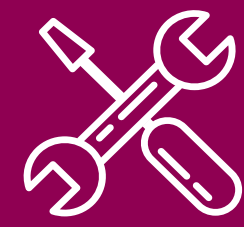

ALL CAPPS
by CSRWB

**The Perfect Way To
Cap Your Wall Off**

DESIGNED AND MANUFACTURED BY
CS RETAINING WALLS BRISBANE

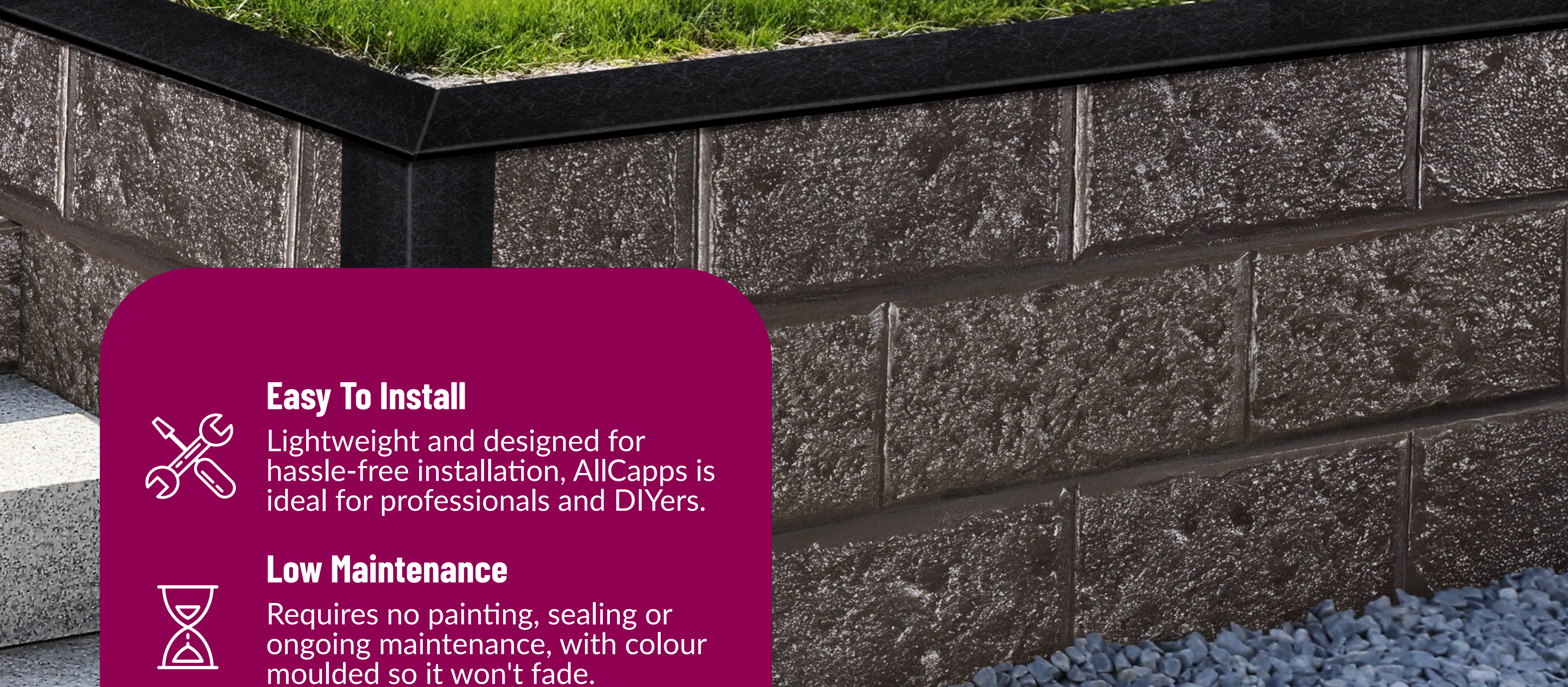

Easy To Install

Lightweight and designed for hassle-free installation, AllCapps is ideal for professionals and DIYers.



Low Maintenance

Requires no painting, sealing or ongoing maintenance, with colour moulded so it won't fade.



Corrosion-Resistant

Engineered to resist damage from the elements, ensuring long-lasting performance in any environment.



Safer, Sleeker Walls

Covers sharp edges and steel posts, making your retaining wall safer and providing a seamless finish.



Strong & Durable

AllCapps weighs less than steel yet is just as strong. Plus, it won't permanently deform under pressure.

**Proudly
Australian designed
& manufactured by
CSRWB**

The Finishing Touch For Retaining Walls

AllCapps is the ultimate capping solution for retaining walls, designed to provide a polished and professional finish while concealing steel posts for a seamless look.

Lightweight, durable, and available in a variety of colours and sizes, AllCapps is easy to install and built to last.

Whether you're working on a new project or upgrading an existing wall, AllCapps enhances both style and functionality, ensuring your retaining wall stands out for all the right reasons.

ALLCAPPS

A CLOSER LOOK AT OUR CAPPING SOLUTION

EASY TO INSTALL

Simply measure, cut and stick. AllCapps' lightweight FRP also means it's easy to transport, easy to work with and easy to install.

LIGHTER THAN STEEL & ALUMINIUM

AllCapps is lighter than steel and aluminium yet just as strong.

LIFETIME WARRANTY

We back our product with a lifetime warranty. AllCapps is strong and durable, and it won't permanently deform under pressure.

DESIGNED FOR SAFETY

With smooth edges, AllCapps provides a safer, smoother edge to retaining walls.

SUITS ALL SLEEPERS & POST SIZES

AllCapps fits most posts and sleepers on the market so you can use it on any wall you build.

FOR NEW & EXISTING WALLS

AllCapps is a great option to complete new walls but it can also be added to existing walls, regardless of when they were built.

How It Works

Getting started with your AllCapps project is simple!

Begin by selecting the capping colour and size that best suit your design.

Then, use the project planning form at the back of this brochure to calculate the quantities you'll need and note down all product codes.

Finally, place your order and either pick up your order or choose to have it delivered direct to you.

Need help?
Our friendly team is here to guide you through every step and ensure you have everything you need to bring your vision to life.

Call us on 07 3393 9647 or email us on sales@csrwb.com.au



SELECT PRODUCTS

Choose the colour and width that best suits your project. Then measure your wall & calculate the quantities you'll need (see planning tool at the back of this brochure).



ORDER ALLCAPPS

Place your order by phone 07 3393 9647 or go to www.allcapps.com.au to buy online. Use the planning tool to make a note of product codes for easier ordering.



GET IT HOME

AllCapps' light weight means it can be easily picked up or delivered. Simply select your preferred method of receiving your order with us when you order.



INSTALL WITH EASE

Use our handy installation guide to easily install your AllCapps. Cut your AllCapps to size, apply adhesive then place over posts and tops of sleepers. Simple!

SELECT YOUR ALLCAPPS

Available in a range of sizes to suit various steel posts, AllCapps hides exposed posts and enhances the overall appearance of your wall, making it both safer and more stylish.

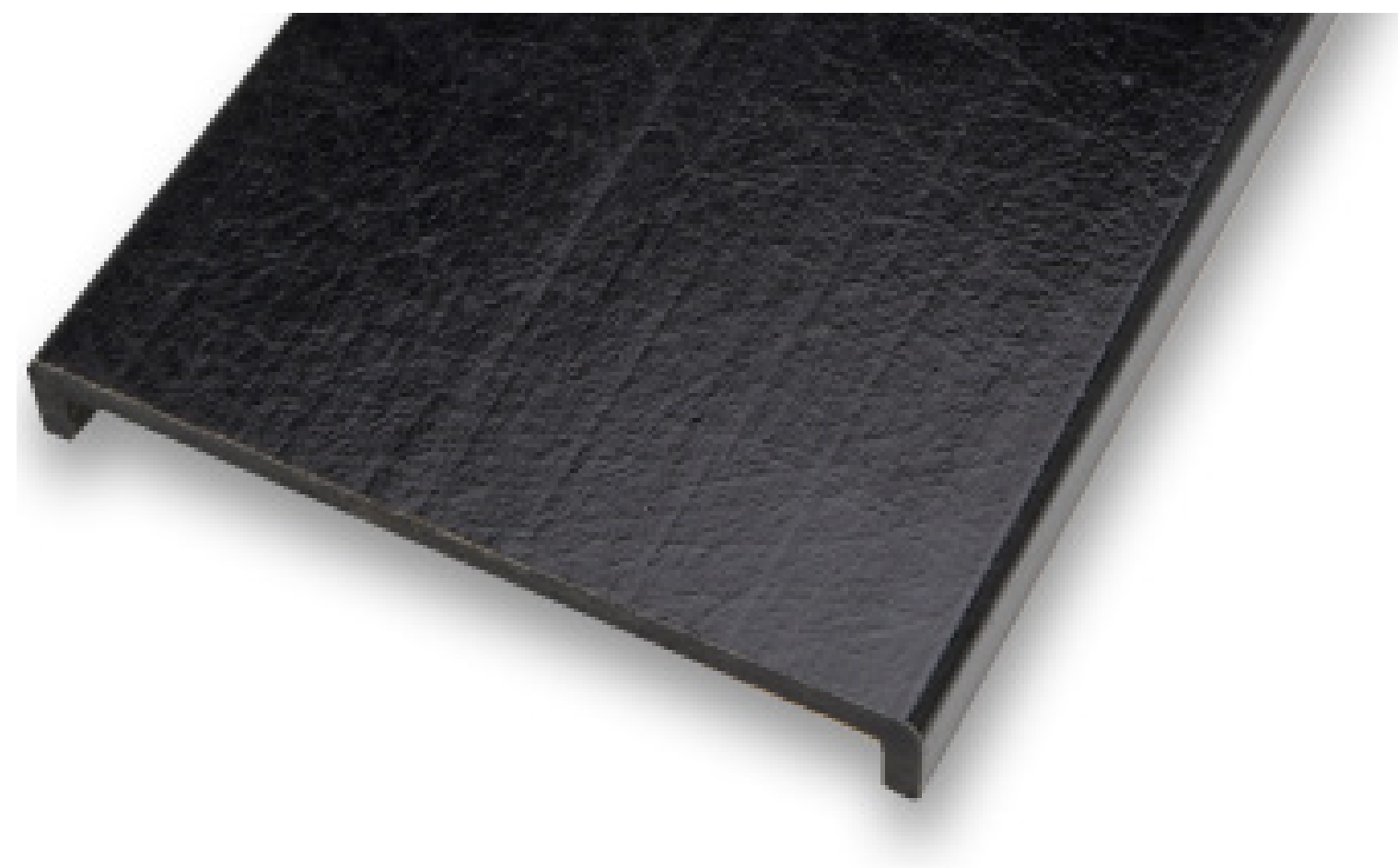

Graphite

ITEM	ITEM NO.
For 65mm Posts (1.6m)	C65GG16
For 100mm Posts (2.2m)	C100GG22
For 100mm Posts (2.6m)	C100GG26
For 150mm Posts (2.6m)	C150GG26



Concrete Grey

ITEM	ITEM NO.
For 65mm Posts (1.6m)	C65CG16
For 100mm Posts (2.2m)	C100CG22
For 100mm Posts (2.6m)	C100CG26
For 150mm Posts (2.6m)	C150CG26



Don't Leave Retaining Walls Unfinished...

Effortless installation. Incredible impact.

AllCapps is designed to transform retaining walls with its sleek, durable, and easy-to-install capping solution.

By concealing exposed steel posts, AllCapps not only enhances the visual appeal of your wall but also adds an extra layer of protection against the elements.

Installing AllCapps is fast becoming the *only* way to finish retaining walls. It's also an incredible way to refresh existing walls and give them a new lease on life.

Cover Up With AllCapps

AllCapps covers up the parts of your wall that you don't really want exposed! From the rough top edge of your sleepers, to sharp corners and unsightly steel posts, AllCapps was designed to cover it all!



TOP EDGE

Give your retaining wall a professional finish by capping the top edge. AllCapps hides uneven surfaces and creates a smooth, uniform look that's both stylish and functional.



CORNERS

Sharp, exposed corners can be both unsightly and hazardous. AllCapps provides a clean, polished finish for corners, softening edges and improving the overall appearance of your wall.



STEEL POSTS

Exposed steel posts can detract from the visual appeal of your wall. AllCapps fits securely over all post sizes, providing a sleek, modern finish while improving safety.



Easy To Install. Safe To Enjoy.

Designed with safety in mind.

AllCapps retaining wall capping covers rough and sharp edges and minimises risks of injury if corners are fallen on.

It is an excellent choice for low-set retaining walls in high-traffic areas or in places where children or the elderly frequent.

It is fast becoming the retaining wall must-have in spaces where safety is paramount.

Ensure your wall ticks all the safety boxes!

Install AllCapps on your next project or add a new element of safety to an existing project.

THE MUST HAVE FOR HIGH-TRAFFIC SPACES

Our AllCapps Capping is a vital safety component for retaining walls; an especially important factor when installing walls in the following places..



**CHILDCARE
& SCHOOLS**



**AGED
CARE**



**COMMERCIAL
SPACES**



**RESIDENTIAL
GARDENS**

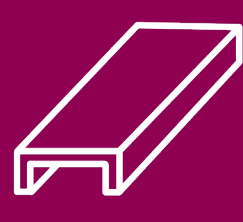

EDGING



STAIRWAYS



A Quality Product Backed By Lifetime Warranty

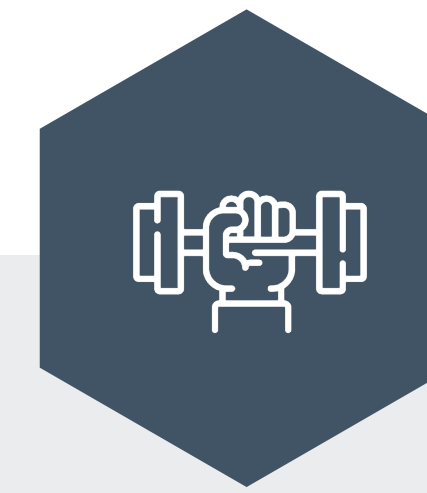

UNPARALLELED DURABILITY

Built to withstand the harshest conditions, our products are made to endure Australia's toughest climates without compromising on strength or style. Plus, we offer support in creating a strong foundation with high quality drainage solutions.



LOW MAINTENANCE

Designed for durability, our sleepers and accessories require minimal upkeep, saving you time and effort over the years. For added support, your sleepers come with aftercare advice so you can keep your wall looking like new.



LIFETIME WARRANTY

Rest assured knowing your investment is protected. Our sleepers come with lifetime warranty coverage, giving you peace of mind and confidence in the quality of your wall for years to come.

At CS Retaining Walls Brisbane, our commitment doesn't end when you complete your purchase. We're here to support you every step of the way, offering expert advice for ongoing maintenance, warranty coverage for peace of mind, and a team ready to assist whenever you need help.

Your project's success is our priority, long after the materials are delivered.

	AllCapps (Pultruded FRP)	Steel (A 709 Grade 50)	Aluminium (6061-T651 & 6061-T6)	Wood (Douglas Fir)
CORROSION, ROT & INSECT RESISTANCE	Resists a broad range of chemicals and is unaffected by moisture or immersion in water. Resists insect damage.	Subject to oxidation and corrosion. Requires painting or galvanizing for many applications.	Can cause galvanic corrosion. (Anodizing and other coatings increase corrosion resistance.)	Can warp, rot and decay when exposed to moisture, water and chemicals. Susceptible to attack by insects.
WEIGHT	Weights 75% less than steel and 30% less than aluminum.	Could require lifting equipment to move and place.	Lightweight — about a third of the weight of copper or steel.	Specific gravity 0.48
STRENGTH	Has greater flexural strength than timber and pound-for-pound is often stronger than steel and aluminum in the lengthwise direction.	Homogeneous material. Yield strength (Fy) = 36 ksi.	Homogeneous material. Flexural strength (Fu) = 35 ksi.	Modulus of rupture is 12,000 psi
IMPACT RESISTANCE	Will not permanently deform under impact. Glass mat in pultruded parts distributes impact load to prevent surface damage.	Can permanently deform under impact.	Easily deforms under impact.	Can permanently deform or break under impact.
COLOUR	Colour is moulded through; no painting required. Variety of colours available.	Must be painted for colour, and may require repainting over time.	Colours require prefinishes, anodic coatings and paints. Mechanical, chemical and electroplated finishes can be applied.	Must be primed and painted for colour, and may require repainting over time.
COST	Lower installation costs, less maintenance and longer product life allow for a lower lifecycle cost.	Lower initial material cost.	Part price comparable to FRP.	Has a lower initial cost, but usually requires more maintenance and replacement.
FABRICATION	Can be field-fabricated using simple carpenter's tools with carbon or diamond tip blades — no torches or welding required.	Often requires welding and cutting torches. Heavier material requires special equipment to erect and install.	Good machinability (welding, brazing, soldering or mechanical joining).	Can be field-fabricated using simple carpenter's tools.
DENSITY (LB/FT3)	107-120	490	169	30
TENSILE STRENGTH (PSI)	30,000 (LW) 7,000 (CW)	65,000	45,000	-
TENSILE MODULUS (X 106 PSI)	2.8 (LW) 1 (CW)	30	10	-
FLEXURAL STRENGTH(PSI)	30,000 (LW) 10,000 (CW)	65,000	45,000	12,000
FLEXURAL MODULUS (X 106 PSI)	1.8 (LW) 0.8 (CW)	30	10	1.6-1.8
THERMAL CONDUCTIVITY (BTU IN. /(HR FT2 °F))	4	323	1,165	13
THERMAL EXPANSION (X 10-6 IN./IN./°F)	7-8	6-7	13	1.7-2.5

Built with Precision. Delivered with Care.

At CS Retaining Walls Brisbane, we take pride in our exceptional control over quality at every stage of production, whether it be in-house manufacturing or with trusted suppliers. This means you can trust that every product meets the highest standards of durability and performance.

Our commitment doesn’t end there. We believe in delivering an outstanding customer experience, from helping you plan your project to ensuring timely delivery of your materials. Your satisfaction is our priority.



Why Choose CS Retaining Walls Brisbane?

SUPERIOR QUALITY

Manufactured on-site with premium materials and a team dedicated to attention to detail and strict quality control.

DEDICATED SUPPORT

With our friendly team at the end of the phone, you’ll have a direct line for advice, ordering, and ensuring your project runs smoothly.

FAST, RELIABLE, CONVENIENT

With many items in stock, quick turnaround for others, and next-day delivery, we get your materials to you fast and hassle-free.

STOCK AVAILABILITY

In-house manufacturing means consistent supply. For steel, our huge inventory means we have what you need at the prices you’ll love.

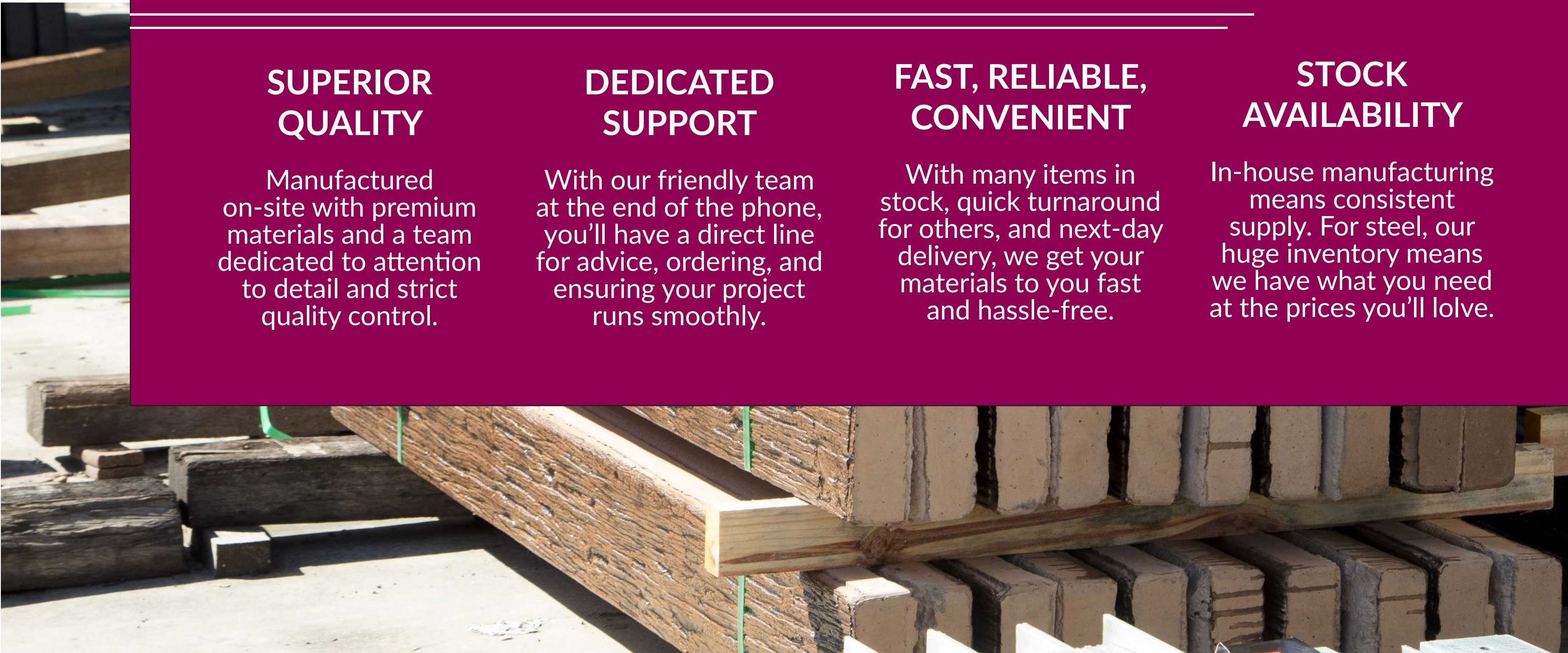

Your One-Stop Retaining Wall Shop

At CS Retaining Walls Brisbane, we believe in providing complete solutions, not just products. That's why we offer everything you need to build your retaining wall; not just the sleepers.

RETAINING WALL POSTS

You can rely on us for great stock levels, a huge range of sizes and weights and consistent quality. Our buying power allows us to pass on savings to you and our stock and size availability means less wastage - and even more savings!

- » **65 UC/PFC Posts** suited to 50mm sleepers (CS Mini) - from 0.3m to 1.8m
- » **100 UC/PFC Posts** suited to 75mm sleepers
- » **150-200 UC/PFC Posts** suited to 75mm and 100mm sleepers - from 2.4m to 5.8m
- » **Civil Series Posts with welded REO Bars** - from 0.4m to 2.4m

ACCESSORIES

With our range of essential drainage solutions like Geo Fabric and Agg Pipe, and construction supports (from spray paint to lifting equipment), we're your one-stop shop for all your retaining wall needs.

SLEEPER SOLUTIONS

CS SIGNATURE

Our signature range of high-quality sleepers designed for almost all projects.

CS Mini
THE LIGHTWEIGHT SLEEPER

Lightweight concrete sleepers for tight access & DIY walls up to 900mm.

ECOSLEEPER
RETAINING WALL SYSTEMS

Ecofriendly sleepers under 6kg each for eco-friendly DIY retaining wall projects.

CS PANEL

One-lift panels for quick and efficient commercial retaining wall builds.

PRODUCT ADVICE

We're always at the end of the phone to answer any questions you may have about our products and get support on which products are the best for your project.

PROJECT PLANNING

We've included a handy planning tool at the back of this brochure to help you work out what you need for your project and write down the products you want.

EASY ORDERING

Simply email us on sales@csrwb.com.au or call us on 07 3393 9647 with your product codes and quantities. You can even send us a picture of your completed planning form (found on the next page).

You can also buy online at www.allcapps.com.au

STOCK AVAILABILITY

Many of our items are always in stock, but our most popular sleepers may have a wait of up to 10 days. You will be advised about your Order Ready date when you order.

DELIVERY OR PICK UP

Our fleet of trucks delivers throughout Queensland and northern New South Wales daily. We can arrange next day delivery on stocked items. If you prefer to pick up, you can do so at our Hemmant warehouse.

AllCapps' light weight also means that it can be couriered to you Australiawide.

INSTALLATION

AllCapps is easy to install and your order comes with a handy installation guide to make installation even easier!



AllCapps Capping

Quick Install Guide

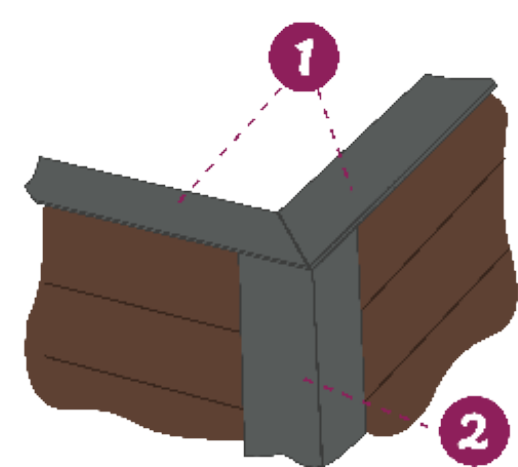

Top first, posts second

There is no right or wrong way to install AllCapps but we recommend capping the sleepers and then the posts.

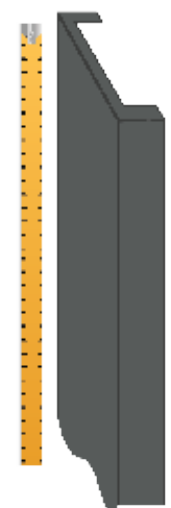

Measure & cut

We recommend cutting and trial fitting it all without glue first. Start at the edge of the wall and create joins in the center of the posts.

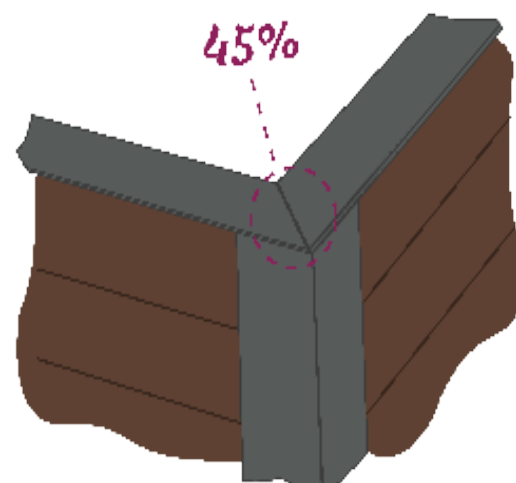

Installing corner pieces

You can butt the 2 pieces together, but we recommend cutting the cap at a 45° angle and joining them for the neatest finish.

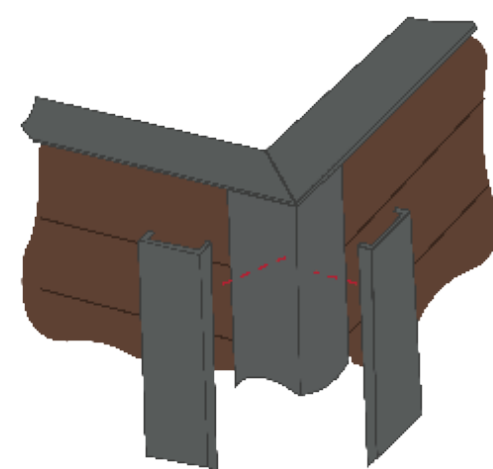

Check capping on posts

Lay your AllCapps capping on your wall and posts to ensure your capping fits prior to applying any glue.

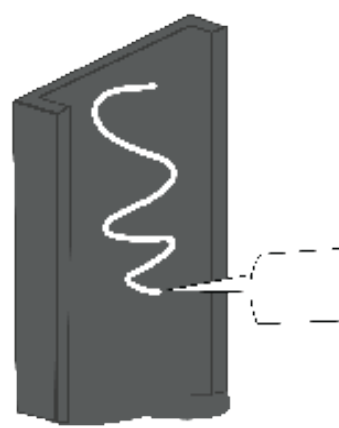

Glue capping in place

Apply glue to the back of the capping. The more surface you cover with glue the more of the cap will stick holding the capping on stronger.



Get the Complete AllCapps Installation Guide

Scan the QR code below to access our more detailed AllCapps Installation Guide.

PROJECT DETAILS

	SEGMENT 1	SEGMENT 2	SEGMENT 3	SEGMENT 4	SEGMENT 5
WALL HEIGHT					
ALLCAPPS FOR TOP SLEEPER EGDE					
# SLEEPER BAYS					
BAY WIDTH					
ALLCAPPS LENGTH					
ALLCAPPS QTY					
ALLCAPPS FOR POSTS					
# H POSTS					
# C POSTS					
# CORNER POSTS					
ALLCAPPS LENGTH					
ALLCAPPS QTY					

PRODUCTS REQUIRED

COLOUR	LENGTH	FOR POST SIZE	CODE	QUANTITY

PLANNING TIPS

Use the Project Details section to calculate the AllCapps you'll need.

MAP OUT WALL SEGMENTS

If your retaining wall is not a consistent height, fill in a new segment for each height.

If your wall is a consistent height, you can map out your materials in the SEGMENT 1 column only.

CALCULATE ALLCAPPS FOR TOP EDGE

First, count the number of sleeper bays per segment and write down the bay width (your sleeper length). Then choose the best length for your sleeper bay.

1 x 2.6m cap per 2390mm bay.
1 x 2.2m cap per 1990mm bay.
1 x 2.2m or 2.6m cap per 1590mm bay.
1 x 1.6m cap per 1500m bay.

CALCULATE ALLCAPPS FOR STEEL POSTS

1 x cap per H-Post.
2 x caps per C-Post & corner.

Capping comes in 1.6m, 2.2m and 2.6m needs to be cut so choose the length that provides the least wastage.

Consider your posts size before selecting lengths.

1.6m AllCapps is for 65UC / PFC Posts.

2.2m and 2.6m AllCapps is for 100UC / PFC Posts.

2.6m AllCapps is also available for 150UC/ PFC Posts.



WWW.ALLCAPPS.COM.AU

DESIGNED AND MANUFACTURED BY



WWW.CSRWB.COM.AU | 07 3393 9647 | 7/237 FLEMING RD, HEMMANT